



**FARROW**  
ESTATE AGENTS



52 Colin Avenue, Grimsby, DN32 8EP

Asking price £150,000



**FARROW**  
ESTATE AGENTS





Floor Plan

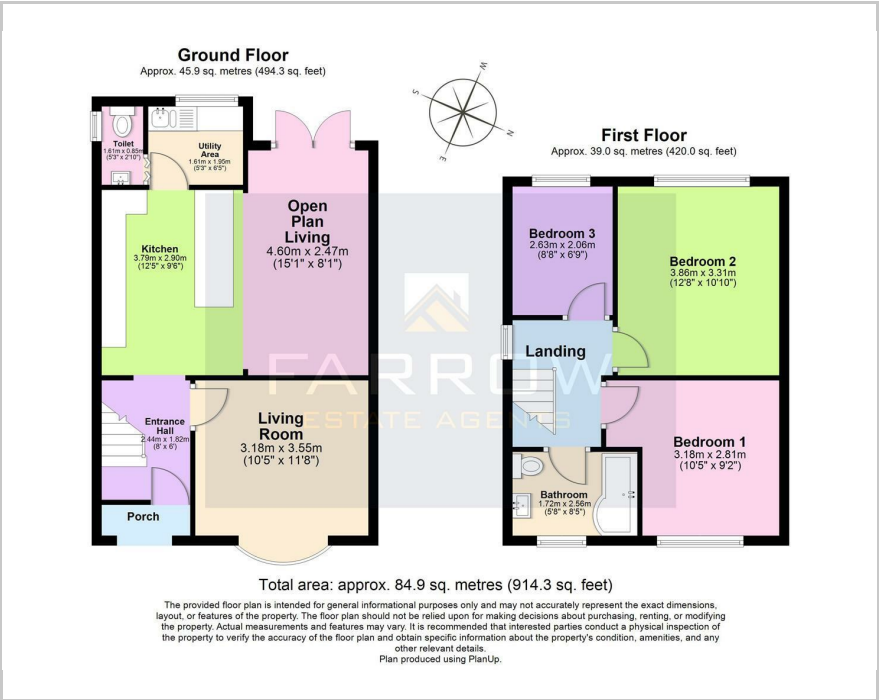

Area Map



Accommodation

- Ideal For First Time Buyers / Investors / Downsize
- Private Driveway
- Prominent (DN32) Location
- Great Schools Catchment Area
- Two Reception Rooms
- Well Maintained Rear Garden
- Walking Distance To Weelsby Woods
- Short Walk To Amenities
- Easy Access To Both Grimsby & Cleethorpes Town Centres
- Freehold

Viewing

Please contact our Farrow Estate Agents Office on 01472 355864 if you wish to arrange a viewing appointment for this property or require further information.

Energy Efficiency Graph

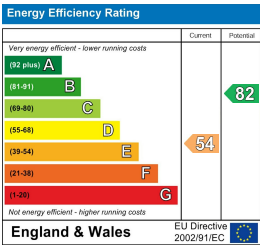

These particulars, whilst believed to be accurate are set out as a general outline only for guidance and do not constitute any part of an offer or contract. Intending purchasers should not rely on them as statements of representation of fact, but must satisfy themselves by inspection or otherwise as to their accuracy. No person in this firms employment has the authority to make or give any representation or warranty in respect of the property.